

SC/SU Series Standard Cylinder

Overall Dimensions

SC

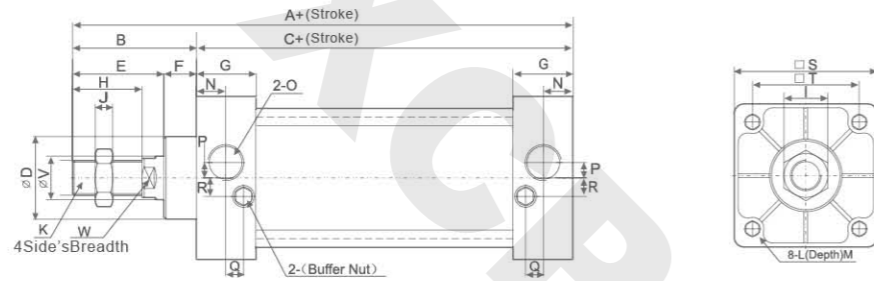

SCD

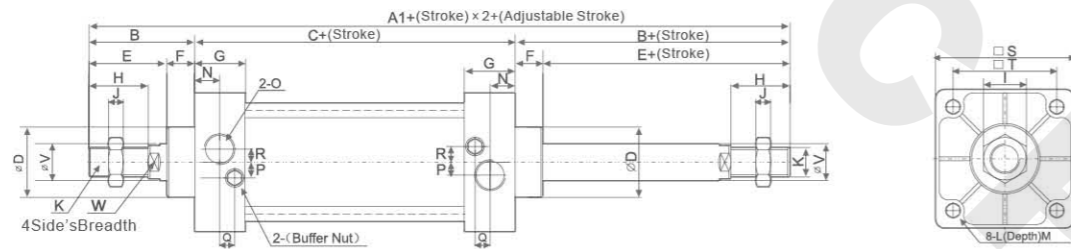

SCJ

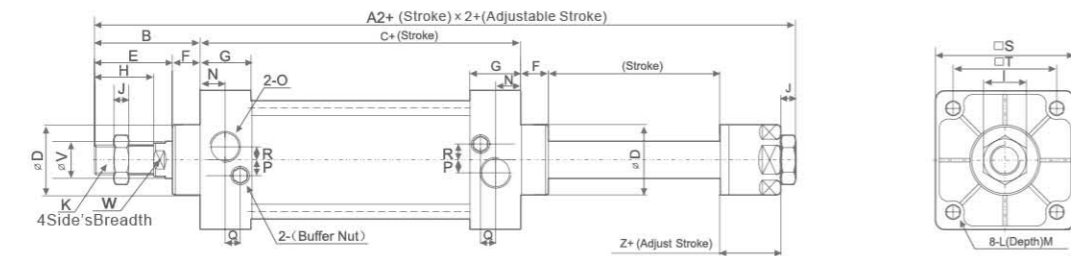

Dimension Sheet

Bore/Symbol	A	A1	A2	B	C	D	E	F	G	H	I	J	K
32	140	187	182	47	93	28	32	15	27.5	22	17	6	M10×1.25
40	142	191	185	48	93	32	34	15	27.5	24	17	7	M12×1.25
50	150	207	196	57	93	36	42	15	27.5	32	23	8	M16×1.5
63	153	210	199	57	96	36	42	15	27.5	32	23	8	M16×1.5
80	183	258	242	75	108	47	54	21	33	40	26	10	M20×1.5
100	183	258	248	75	108	47	54	21	33	40	26	10	M20×1.5
125	239	342	363	104	136	56	71	32	40	54	36	10	M27×2
160	289	412	450	121	166	65	93	30	50	72	50	16	M36×2
200	337	494	451	132	180	75	100	57	50	72	50	16	M36×2

Bore/Symbol	L	M	N	O	P	Q	R	S	T	V	W	Z
32	M6×1	9.5	13.7	G1/8"	3.5	7.5	7	45	33	12	10	21
40	M6×1	9.5	13.5	G1/4"	6	8.2	9	50	37	16	14	21
50	M8×1	9.5	13.5	G1/4"	8.5	8.2	9	62	47	20	17	23
63	M8×1.25	9.5	13.5	G3/8"	7	8.2	8.5	75	56	20	17	23
80	M10×1.5	11.5	16.5	G3/8"	10	9.5	14	94	70	25	22	29
100	M10×1.5	11.5	16.5	G1/2"	11	9.5	14	112	84	25	22	29
125	M12×1.75	21	16.5	G1/2"	/	/	/	140	4110	32	28	33
160	M16×2	25	26	G3/4"	/	/	/	180	140	40	36	38
200	M16×2	25	22.5	G3/4"	/	/	/	220	175	40	42	42

MB Series Standard Cylinder(Japanese standard)



Ordering Code

MB 50 × 50 - S - □
 Series Code: Japanese standard Double Action Type
 Cylinder Bore: 32mm-100mm
 Stroke: 50
 Magnet Code: S (With Magnet)
 Fixed Type: □ (Basic type)

Internal structure

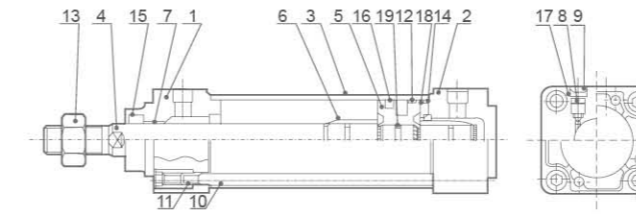

NO	Designation	NO	Designation	NO	Designation
1	Front cover	6	Buffer ring	11	Tie rod nut
2	Back Cover	7	Bearing	12	Wear ring
3	Barrel	8	Cushion Screw	13	Piston rod nut
4	Piston rod	9	Cushion Seal	14	Buffer seal ring
5	Piston	10	Tie rod	15	Piston O-ring

Specification

Cylinder Diameter	32	40	50	63	80	100
Working Medium	Air					
Action Type	Double acting					
Proof Pressure	15.3kgf/cm ² (1.5Mpa)					
Max.Pressure	10.2kgf/cm ² (1.0Mpa)					
Min.Pressure	0.5kgf/cm ² (0.05Mpa)					
Environment and Fluid Temp	-10~+60°C					
Piston Velocity	50~1000mm/s					
Buffering	Air buffering					
Stroke Tolerance	0~250 ⁺¹⁰ ₀ , 251~1000 ⁺¹⁴ ₀ , 1001~1500 ⁺¹⁸ ₀					
Rc(PT)Joint size	G1/8"	G1/4"	G3/8"	G1/2"		

Stroke

Bore	Standard Stroke
32	25,50,75,100,125,150,175,200,250,300,350,400,450,500
40	25,50,75,100,125,150,175,200,250,300,350,400,450,500
50	25,50,75,100,125,150,175,200,250,300,350,400,450,500,600
63	25,50,75,100,125,150,175,200,250,300,350,400,450,500,600
80	25,50,75,100,125,150,175,200,250,300,350,400,450,500,600,700,750
100	25,50,75,100,125,150,175,200,250,300,350,400,450,500,600,700,750

Overall Dimensions

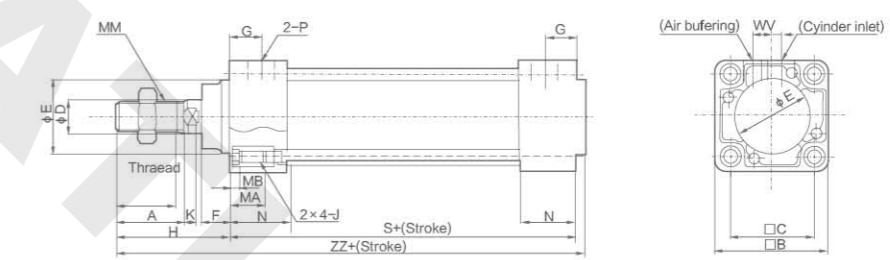

Dimension Sheet

Bore/Symbol	Stroke range	Thread Length Available	A	□B	□C	ΦD	ΦE	F	G	MA	MB	J	K	MM	N	P	S	V	W	H	ZZ
32	~500	19.5	22	46	32.5	12	30	13	13	16	4	M6×1.0	6	M10×1.25	27	1/8	84	4	6.5	47	135
40	~500	27	30	52	38	16	35	13	14	16	4	M6×1.0	6	M14×1.5	27	1/4	84	4	9	51	139
50	~600	32	35	65	46.5	20	40	14	15.5	16	5	M8×1.25	7	M18×1.5	31.5	1/4	94	5	10.5	58	156
63	~600	32	35	75	56.5	20	45	14	15.5	16	5	M8×1.25	7	M18×1.5	31.5	3/8	94	9	12	58	156
80	~750	37	40	95	72	25	45	20	19	16	5	M10×1.5	10	M22×1.5	38	3/8	114	11.5	14	72	190
100	~750	37	40	114	89	30	55	20	19	16	5	M10×1.5	10	M26×1.5	38	1/2	114	17	15	72	190